

# Mid-Bucks (Aylesbury) u3a

[www.u3a.co](http://www.u3a.co)

## Newsletter – March 2026

Editor: Solo Awadzi - Email: [solokawadzi23@gmail.com](mailto:solokawadzi23@gmail.com)

Meet at Community Centre, Prebendal Avenue

1.30 p.m. for start at 2.00 p.m.

Free Refreshments available.



### **SPEAKER - 19<sup>th</sup> March 2026 - Tony Lyster - *Bucks (Quinton) Railway.***

Tony is a volunteer vintage carriage restorer at the Buckinghamshire Railway Centre. He enjoyed a varied working life with lots of different experiences but is now retired and enjoys spending time restoring and maintaining the Victorian railway carriages. One of his projects won an award from the National Transport Trust in 2021. We will look forward to hearing how he is getting on!

### **SPEAKER - 16th April - Keith Muras - *Guerrillas in the mist.***

**SPEAKER - 21st May - Gemma Kitching Cancer Research UK - *History and progress of life-saving research.***

**SPEAKER - 18<sup>th</sup> June 2026 - Paul Ranford - *How Victorian England reacted to Darwin's unsettling news.***

### **CHAIRMAN'S REPORT - Colin White**

Welcome to our Newsletter for March 2026. As I write this the sun is shining and it feels pleasantly warm, is spring with us already?

I'd like to give you all another reminder to have a think about being put forward for one of the roles on the Branch Committee - Chairman, Vice-Chairman, Secretary, Treasurer, Membership Secretary, Newsletter Editor, Trips Organisers and Website Managers. I am sure the current incumbents are willing to stand once again, but this cannot always be taken for granted, and there's nothing wrong with some healthy competition. Please note that nominations should be made well in advance of the AGM in May when the elections take place. I will send out an email with the Committee Nominations form attached.

I'd like to thank David Wilson for agreeing to take over the examination of our accounts from next year, and I'd also like to thank Cyril Parsons for doing this over the last few years.

I recently sent out a reminder about the need to carry our ICE cards (In Case of Emergency) with us when we go on any trips or outings, particularly if we are on our own. If you cannot locate your card you could make your own, and it would be wise to include the information I put in the recent email.

In order to ensure that all those coming on coach trips are covered by relevant insurances they should be members of the u3a, or a required registered carer. If you have any queries please get in touch with a member of the Trips Team.

You'll all be aware that we have been experiencing a drop in member numbers over the last few years. This has had a lasting and continuing impact on the Branch's finances. Can I encourage you all to invite your friends and family to join us? If you are aware of people who attend our groups and come from other u3as please encourage them to join our branch. The cost to join is not excessive and the income we receive does make a difference in the end.

Accompanying the email that includes this Newsletter is a copy of the Branch Membership Renewal form. Please fill this in as soon as possible if you are wishing to renew your membership, and bring it along to a monthly meeting, or post it to Wendy. Memberships expire at the end of March, so the clock is ticking! Please note that Membership Cards will not be available until June, because Committee positions need to be resolved at the AGM in May, and prior to printing the cards.

### **LOCAL HISTORY GROUP - Jasmine & Simon Reeks**

**March Meeting – Friday 27th March, 12 noon, Lady Chapel, St Mary's Church, Aylesbury.** Movers & Shakers of Old Aylesbury: a talk by Terry Bloxham on two families who have had Memorials erected in the Lady Chapel. £4.00 per person

Simon & I will be in the Temple Coffee, 1 Temple Street from 11.00. Buy your own refreshments. Or see you in the main church from 11.40. The Lady Chapel is not available until noon as it is a venue for Private Prayer. Please do not enter until Terry invites you in.

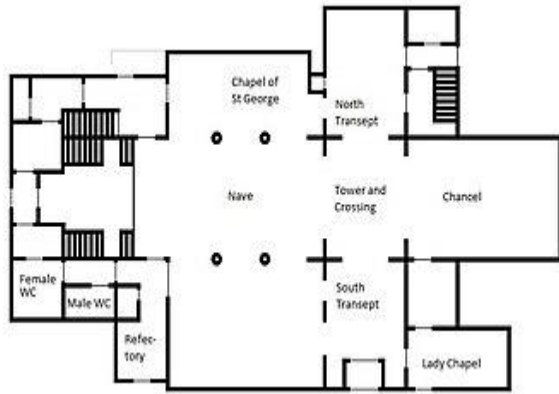

Copyright Wikipedia

### **March, note change of day, date and time**

**April meeting - We are still looking to book, waiting for available slots to be released**

**May Meeting Thursday 28<sup>th</sup> May Ascott Estate, Wing, Ascott LU7 0PT. Meet at 13.30 in the Cricket Ground**

**Car Park (for those of you who haven't visited for years!). The House is signposted from the main road.** Those who have opted for the Garden Tour, it starts at 14.00. Free roamers, do what you will. We will meet up for refreshments (pay for your own choice) in the Long Room at the back of the Tea Pavilion. Timing to be arranged on the day. For those on the Garden Tour, you then have time to visit the House. The site closes at 17.00, so aim to leave by 16.30 but you can head for home before. Numbers have been confirmed and finalised with the National Trust but for exceptional circumstances do speak to us.

Nb. The Fire Brigade haven't responded to an email enquiry and the Police Station no longer offer tours.

### **JIGSAW TABLE - Julie Leach**

The suggested contribution for a jigsaw is 50p. Our supply of puzzles is good at the moment. However, we are always grateful for any donations that are made, and if we don't sell them they will still go to a good home. If you have finished a jigsaw that you previously obtained from the table, why not donate it to another worthy cause such as a charity shop?



## QUIZ GROUP - Ann Burman (07709 226884 / 01296 422084)



The next Quiz will take place on **Tuesday 17<sup>th</sup> March 2026 at Foxhill Indoor Bowls Club, starting at 2.00pm. Cost £2 per person** (including tea/coffee and biscuits). All members are welcome. It would be nice to see some new faces, why not give it a go?

*Quiz is normally on the third Tuesday in the month, apart from December when we do not meet.*

## HISTORY OF TRANSPORT – Simon & Jasmine Reeks

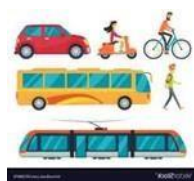

At our March meeting (**14.30 on Wednesday 18th March, 9 Barge Crescent, Broughton, Aylesbury, HP22 7BH**) we will be looking at the splendid technological achievement of the Falkirk Wheel.

Any queries, please contact us by phone/email on **01296 482735 / [reeks@fangio.co.uk](mailto:reeks@fangio.co.uk)**

## MUSICAL APPRECIATION - Jim Wilding (01296 623628)



Our next meeting will be on **Tuesday 24th March, 2.30 at 9 Mill Mead, Wendover**. Having had to cancel the February meeting, hope that you can all make it!

## GADGET GROUP - Simon Reeks

Things achieved over the last month or so include duplicating some music CDs, helping with a Chromebook, sorting out a hacked email and helping set up a new mobile. By pure coincidence, I helped to resurrect 3 scanners - if you are struggling with a scanner I have a very nice free program available that helps sort things out.



I "play" with many gadgets, for example PCs, laptops, Android phones (including connection to get SatNav onto car screens via Android Auto), televisions, printers etc. As long as Apple is not involved, I'll happily try to help. Please

contact me by phone/email on **01296 482735** / [reeks@fangio.co.uk](mailto:reeks@fangio.co.uk) and I'll see what I can do.

## **COACH TRIPS 2026**

**Pickup points: Exchange Street 9.00 am / Tennis Club 9.05 am / Jansel Square 9.15 am.**

**Wimpole Estate Tuesday 14<sup>th</sup> April** – Please pay for this trip at the March meeting.

£16 (NT members) or £35 (non-members)

You can pay by cash, by cheque (payable to Mid-Bucks (Aylesbury) u3a), or by bank transfer (to Mid-Bucks (Aylesbury) u3a Metro Account, Number 47992982 Sort code 23-05-80

**Please remember to include 'Wimpole' and your surname in the payment details.**



(Image copyright - National Trust.)

**Lead Jan Paver (07768 205950)**

**The Savill Garden, Windsor Great Park Thursday 14<sup>th</sup> May.**

A 35-acre haven of gardens, woodland and seasonal displays.

**Cost: £25** This should include a guided tour of the main areas of the gardens. (TBC)!

Please make your own arrangements for lunch. Visit the website to book the restaurant if you want this option, (we suggest 1.00 pm after the tour). Alternatively, other cafés for light bites are available. You can sign up for this trip at the March or the April meeting.

**Lead Val Blackburn (07923 023064)**

## **Upcoming trips**

- 10<sup>th</sup> June Chichester or East Wittering Beach
- 1<sup>st</sup> July Kelmscott Manor and Lechlade
- 8<sup>th</sup> September Boat trip on Rutland Water and Burghley House

## **PUB WALKS – Colin White (07941 652918)**

The next pub walk will take place on **Thursday 2<sup>nd</sup> April**, meeting for an **11:00** start at **The Harrow at Bishopstone, HP17 8SF**. Bishopstone is located in the countryside to the south west of Aylesbury.

The walk is just over 3½ miles long and is generally on the flat. There are a couple of short bits of on-road walking. There are 5 stiles.



Please sign up at the March monthly meeting or call Colin (07941 652918) if you would like to join us. All welcome.

Please note that if you are staying for lunch you will need to pre-order using the menu that will be available at the March monthly meeting, and will need to pay a £10 deposit (an overall deposit has already been paid by Colin).

Photo © cafe-restaurant-bar.uk

## **BOWLS GROUP – Colin White (07941 652918)**

The Bowls Group meets and plays at the Foxhill Indoor Bowls Club.

The next sessions take place from **2:30 to 4:30 on Sundays: 15<sup>th</sup> and 29<sup>th</sup> March and 12<sup>th</sup> April 2026** (meet at 2:15pm). The sessions will cost **£5 per person** (which includes refreshments).

We will have booking sheets available at the monthly meetings for those interested in coming along to play.



**Please remember that you will need to play in clean, non-marking shoes. Either bring your own or wear a pair provided by the Bowls Club.**

The primary contact for this Group is Colin White (email [colinwhite100@virginmedia.com](mailto:colinwhite100@virginmedia.com)) and the secondary contact is Sandra Chaudhry (07881 768449).

**BRIDGE GROUP – Martin Lock (01296 433838)**

This group meets regularly, on days to be confirmed, at various members houses.

For more information see the branch website or contact Martin Lock.

**SINGING FOR FUN – Sheila Bulpett (01296 622540)**

This Group is run in conjunction with Wendover u3a and takes place from 11:15 to 12:45 on the second Wednesday of the month at Halton Village Hall. The Group is looking for more singers, particularly men.

For more information see the branch website or contact Sheila Bulpett using the number above or [sebulpett@yahoo.co.uk](mailto:sebulpett@yahoo.co.uk) – and remember to say you're from the Mid-Bucks (Aylesbury) branch of the u3a.

**YARN CRAFTERS – Sheila Haldane (01296 488267)**

This Group meets from 2.00 to 4.00pm on the second Monday of the month.

For more information see the branch website or contact Sheila using the number above.

**WEBSITE – Solo Awadzi – (07748 750547) & Colin White – (07941 652918)**

The website is the door to our u3a and in need of contributors to submit items to the website manager who would gratefully publish them. Please contact Solo or Colin using the numbers above or [solokawadzi23@gmail.com](mailto:solokawadzi23@gmail.com) or [colinwhite100@virginmedia.com](mailto:colinwhite100@virginmedia.com)

**Sudoku Puzzle March 2026** (Fill in the puzzle so that every row across, every column down and every 9 by 9 box contains the numbers 1 to 9)

1					7	5	6	
		2	3	5		1		4
4			8	6				
		6			3	7	2	
2	4		7					6
			6	9	2	8		
		7		8	5			
5			2	7			3	
		4						

**Sudoku Puzzle February 2026 solution**

7	9	1	6	5	8	4	2	3
4	3	8	9	2	7	5	1	6
5	6	2	4	3	1	8	9	7
2	5	6	1	9	3	7	8	4
9	7	4	2	8	5	6	3	1
8	1	3	7	4	6	2	5	9
3	4	9	8	7	2	1	6	5
1	2	7	5	6	9	3	4	8
6	8	5	3	1	4	9	7	2

**Next Newsletter latest contribution date – Wednesday 1st April 2026**